

# BE-EASY

## Sizes

	<b>Prof. 79 cm</b> Depth 31 1/8"		<b>Prof. 89 cm</b> Depth 35"		<b>Prof. 99 cm</b> Depth 39"			
79	<b>123 cm</b> 48 3/8"	→ Fenix-NTM®	89	<b>150 cm</b> 59"	→ Fenix-NTM®	89	<b>200 cm</b> 78 3/8"	→ Fenix-NTM®
	<b>123/163/203 cm</b> 48 3/8/64 1/8/79"	→ Fenix-NTM®		<b>150/190/230 cm</b> 59/74 1/8/90 1/2"	→ Fenix-NTM®		<b>200/240/280 cm</b> 78 3/4/94 1/2/110 2/8"	→ Fenix-NTM®
	<b>150 cm</b> 59"	→ Fenix-NTM®		<b>170 cm</b> 66 7/8"	→ Fenix-NTM®			
	<b>150/190/230 cm</b> 59/74 1/8/90 1/2"	→ Fenix-NTM®		<b>170/210/250 cm</b> 66 7/8/82 3/4/98 3/8"	→ Fenix-NTM®			

## Tops 17 mm thick

---

Fenix-NTM®

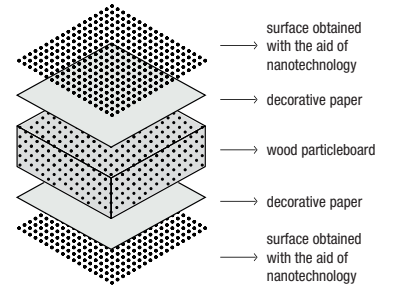
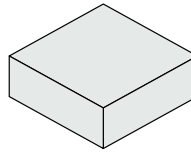

# BE-EASY

## Extensible - Depth 79 cm

### Leg finish:

White lacquered steel (similar to RAL 9016)  
"Fenix-NTM® Ottawa beaver" lacquered steel (similar to RAL Design0805010)  
"Fenix-NTM® London grey" lacquered steel (similar to RAL Design0805005)  
Black lacquered steel (similar to RAL 9004)

### Note:

Under-top bars in anodised aluminium.

Reinforced packaging, see inside cover.

### Finish of top/extensions:

Kos white 0032 Fenix-NTM®  
Ottawa beaver 0717 Fenix-NTM®  
London grey 0718 Fenix-NTM®  
Ingo black 0720 Fenix-NTM®

Code	Lenght	Legs	Top	pack	m <sup>3</sup>	Kg
			Fenix-NTM®			
01BEA01	123-163-203	Lacquered		1	0,27	47
01BEA02	150-190-230	Lacquered		1	0,32	53

### Optionals

Code	Description		pack	m <sup>3</sup>	Kg
02GTA02	Legs height cut to size		-	-	-

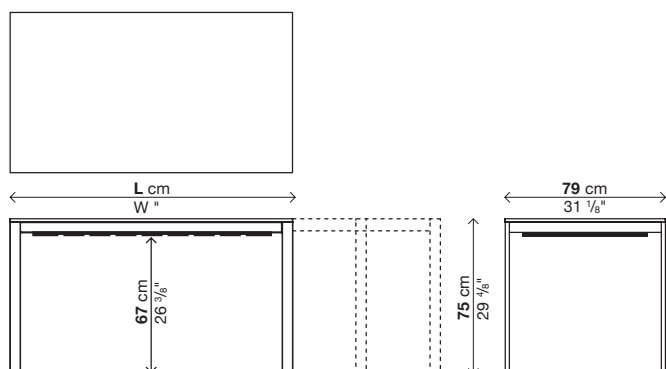

# BE-EASY

## Fixed - Depth 79 cm

### Leg finish:

White lacquered steel (similar to RAL 9016)  
 "Fenix-NTM® Ottawa beaver" lacquered steel (similar to RAL Design0805010)  
 "Fenix-NTM® London grey" lacquered steel (similar to RAL Design0805005)  
 Black lacquered steel (similar to RAL 9004)

### Note:

Under-top bars in anodised aluminium.  
 Reinforced packaging, see inside cover.

### Finish of top:

Kos white 0032 Fenix-NTM®  
 Ottawa beaver 0717 Fenix-NTM®  
 London grey 0718 Fenix-NTM®  
 Ingo black 0720 Fenix-NTM®

Code	Lenght	Legs	Top	pack	m³	Kg
			Fenix-NTM®			
01BEA01F	123	Lacquered		1	0,27	33
01BEA02F	150	Lacquered		1	0,32	38

### Optionals

Code	Description	pack	m³	Kg
02GTA02	Legs height cut to size	-	-	-
02FOR03	Lateral or central cable hole Ø6	-	-	-
02RET09	Plastic cable mesh	1	0,07	1
02VER01	Vertebra, opal white methacrylate	1	0,007	1,5
02CPU07	CPU unit, opal white methacrylate	1	0,14	5,5

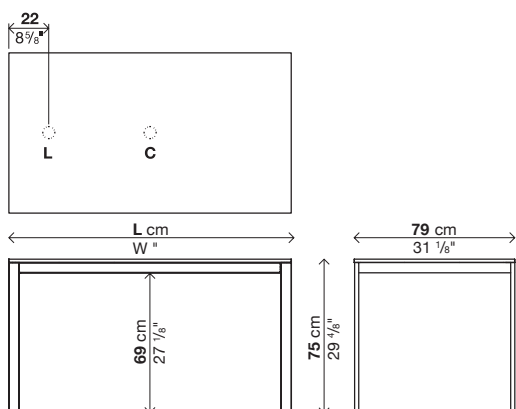

# BE-EASY

## Extensible - Depth 89 cm

### Leg finish:

White lacquered steel (similar to RAL 9016)

"Fenix-NTM® Ottawa beaver" lacquered steel (similar to RAL Design0805010)

"Fenix-NTM® London grey" lacquered steel (similar to RAL Design0805005)

Black lacquered steel (similar to RAL 9004)

### Note:

Under-top bars in anodised aluminium.

Reinforced packaging, see inside cover.

### Finish of top/extensions:

Kos white 0032 Fenix-NTM®

Ottawa beaver 0717 Fenix-NTM®

London grey 0718 Fenix-NTM®

Ingo black 0720 Fenix-NTM®

Code	Lenght	Legs	Top	pack	m <sup>3</sup>	Kg
			Fenix-NTM®			
<b>01BEA05</b>	150-190-230	Lacquered		1	0,36	62
<b>01BEA03</b>	170-210-250	Lacquered		1	0,37	76

### Optionals

Code	Description	pack	m <sup>3</sup>	Kg
<b>02GTA02</b>	Legs height cut to size	-	-	-

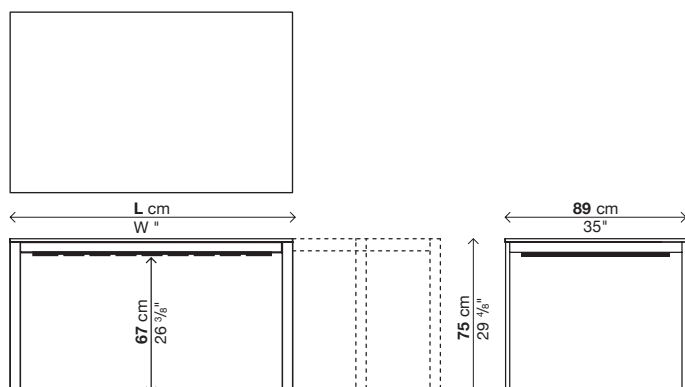

# BE-EASY

## Fixed - Depth 89 cm

### Leg finish:

White lacquered steel (similar to RAL 9016)  
 "Fenix-NTM® Ottawa beaver" lacquered steel (similar to RAL Design0805010)  
 "Fenix-NTM® London grey" lacquered steel (similar to RAL Design0805005)  
 Black lacquered steel (similar to RAL 9004)

### Note:

Under-top bars in anodised aluminium.  
 Reinforced packaging, see inside cover.

### Finish of top:

Kos white 0032 Fenix-NTM®  
 Ottawa beaver 0717 Fenix-NTM®  
 London grey 0718 Fenix-NTM®  
 Ingo black 0720 Fenix-NTM®

Code	Lenght	Legs	Top	pack	m <sup>3</sup>	Kg
			Fenix-NTM®			
01BEA05F	150	Lacquered		1	0,36	40
01BEA03F	170	Lacquered		1	0,37	45

### Optionals

Code	Description	pack	m <sup>3</sup>	Kg
02GTA02	Legs height cut to size	-	-	-
02FOR03	Lateral or central cable hole Ø6	-	-	-
02RET02	Plastic cable mesh	1	0,07	1
02VER01	Vertebra, opal white methacrylate	1	0,007	1,5
02CPU08	CPU unit, opal white methacrylate	1	0,14	5,5

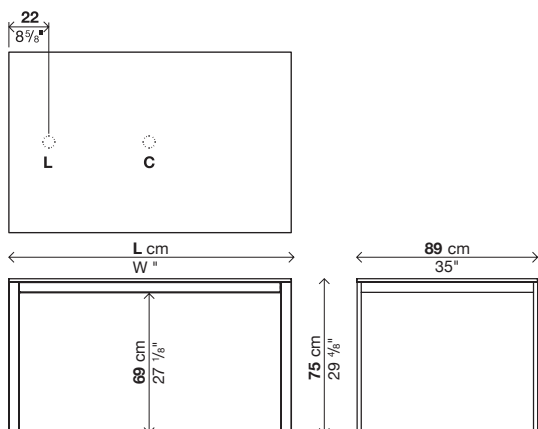

# BE-EASY

## Extensible - Depth 99 cm

### Leg finish:

White lacquered steel (similar to RAL 9016)  
 "Fenix-NTM® Ottawa beaver" lacquered steel (similar to RAL Design0805010)  
 "Fenix-NTM® London grey" lacquered steel (similar to RAL Design0805005)  
 Black lacquered steel (similar to RAL 9004)

### Note:

Under-top bars in anodised aluminium.

Reinforced packaging, see inside cover.

### Finish of top/extensions:

Kos white 0032 Fenix-NTM®  
 Ottawa beaver 0717 Fenix-NTM®  
 London grey 0718 Fenix-NTM®  
 Ingo black 0720 Fenix-NTM®

Code	Lenght	Legs	Top	pack	m <sup>2</sup>	Kg
			Fenix-NTM®			
<b>01BEA04</b>	200-240-280	Lacquered		1	0,5	76

### Optionals

Code	Description	pack	m <sup>2</sup>	Kg
<b>02GTA02</b>	Legs height cut to size	-	-	-

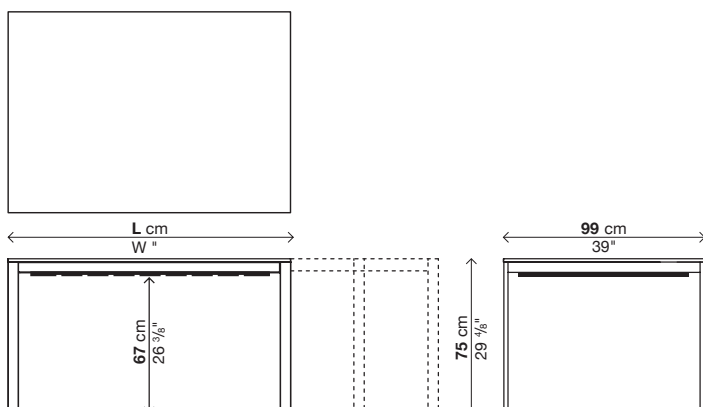

# BE-EASY

## Fixed - Depth 99 cm

### Leg finish:

White lacquered steel (similar to RAL 9016)

"Fenix-NTM® Ottawa beaver" lacquered steel (similar to RAL Design0805010)

"Fenix-NTM® London grey" lacquered steel (similar to RAL Design0805005)

Black lacquered steel (similar to RAL 9004)

### Note:

Under-top bars in anodised aluminium.

Reinforced packaging, see inside cover.

### Finish of top:

Kos white 0032 Fenix-NTM®

Ottawa beaver 0717 Fenix-NTM®

London grey 0718 Fenix-NTM®

Ingo black 0720 Fenix-NTM®

Code	Lenght	Legs	Top	pack	m <sup>3</sup>	Kg
			Fenix-NTM®			
01BEA04F	200	Lacquered		1	0,5	58

### Optionals

Code	Description	pack	m <sup>3</sup>	Kg
02GTA02	Legs height cut to size	-	-	-
02FOR03	Lateral or central cable hole Ø6	-	-	-
02RET03	Plastic cable mesh	1	0,07	1
02VER01	Vertebra, opal white methacrylate	1	0,007	1,5

